



Unique Solutions LabelPlus® 360 is your most versatile, high-performance industrial duty labeller on the market. The Unique Solutions LabelPlus® 360 includes standard features that are optional on most competitive machines. Fits in limited space and handles a wide variety of applications with adjustable labelling point, range 457mm to 762mm.

BENEFITS



Dispenses up to 76mpm/3000ipm with secondary unwind and takeaway thanks to a high-performance stepper motor.



Performs with precision accuracy up to $\pm 0.79\text{mm}$ /1/32".



Ensures there is no waste or downtime from missed labels with product sensing

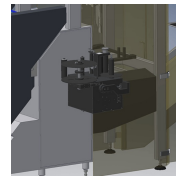

Allows configuration versatility and easy switch between applicators with modular design for merge/wipe-on, tamp, blow-on, corner wrap, swing tamp and VFFS applicator.

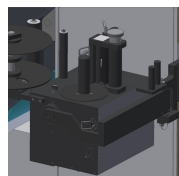

Fast setup and prevents errors by automatically adjusting the sensitivity (with "Auto-Teach" optical sensor) depending on the label running.

STANDARD FEATURES

- High-performance stepper motor
- Product sensing
- Modular design for merge, wipe-on, tamp-on, blow-on, corner wrap, swing tamp and VFFS applicator
- "Auto-teach" optical sensor

APPLICATIONS

- baked snacks
- cereals
- confectionery
- french fries
- fresh produce
- frozen
- snacks

SPECIFICATIONS

US LabelPlus 360	
air consumption L/min (cfm)	up to 113 (4) @ 4 to 6 bar (60-90 psi)
labelling speeds m/min (in/min)	programmable to 76/3000, in excess of 400 labels/min depending upon size
product sensing	Retroreflective scanner
	PLC signal FFS and custom inputs (optional)
label roll size maximum mm (in)	305 (12) OD x 76 (3) ID core
label roll size (optional) mm (in)	406 (16) or 508 (20) OD x 76 (3) or 152 (6) ID cores
label placement mm (in)	±0.79/1/32
dimensions length (mm/in)	889 (35.25) to 1194 (47.25)
dimensions width mm (in)	711 (28) to 737 (29)
dimensions height mm (in)	559 (22.5)
dimensions depth mm (in)	686 (27.5)
power requirements	108-132 VAC, 50/60 Hz, single phase, 5A; 200VAC version available

all above specifications are subject to change and may differ according to product, please confirm when placing your order.

TO FIND OUT HOW YOU AND YOUR TEAM CAN GET THE MOST FROM YOUR TNA SOLUTIONS, CONTACT US

TNA Australia Pty Ltd, 24 Carter Street, Sydney Olympic Park NSW2127, Australia Tel +61 2 9714 2300 Fax +61 297 482 970 tnasolutions.com info@tnasolutions.com